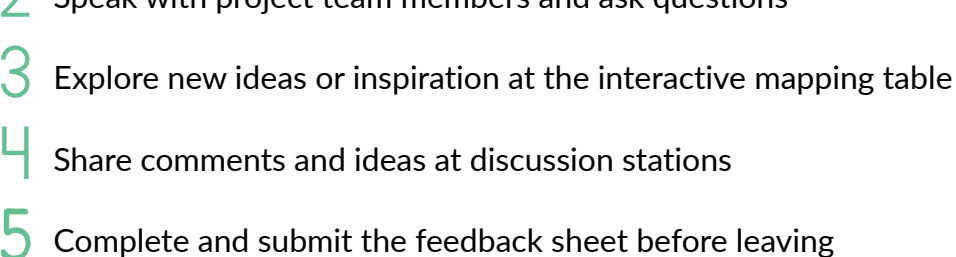

Welcome!

Your Voice, Your Fairgrounds Interactive Open House & Workshop

How to Participate Today

- 1 Review the conceptual option sketches and displays
 - 2 Speak with project team members and ask questions
 - 3 Explore new ideas or inspiration at the interactive mapping table
 - 4 Share comments and ideas at discussion stations
 - 5 Complete and submit the feedback sheet before leaving
- 

What's Included

This information packet includes:

- Workshop Objectives (Page 2)
 - Our Approach to Developing Conceptual Options (Page 3)
 - Site "Givens" & Technical Considerations (Page 4)
 - **Feedback Sheet (Pages 5-7, to be completed and returned before leaving)**
 - Conceptual Option Sketches, & Associated Element Descriptions
-

Why We're Here

The Port Perry Fairgrounds has been part of the community's story for more than a century. This interactive open house and community workshop is part of the Township of Scugog's ongoing community visioning process to explore how the Fairgrounds could continue to serve local citizens, organizations, and future generations.

This workshop is not a final plan or decision-making meeting

Workshop Objectives

- Better Understand Community Priorities:**
Build on what we heard during Round 1 and explore community priorities in greater depth.
- Explore Conceptual Option Sketches:**
Review and discuss a range of possible site arrangements, uses, and amenities.
- Gather Meaningful Feedback:**
Better understand which ideas, elements, relationships, values, and priorities resonate most with participants – and why.
- Inform Future Planning:**
Provide insights that will help guide future concept refinement and long-term planning discussions.

What We're Looking for From You

We encourage you to:

- Share your honest perspectives and ideas
- Think about both current and future community needs
- Consider how different uses could work together
- Reflect on what makes the Fairgrounds unique
- Help identify what feels most important to preserve about the Fairgrounds as the site evolves over time
- Discuss opportunities, concerns, and trade-offs respectfully
- Help us understand the reasons behind your preferences and perspectives (i.e., “the why”)

Different perspectives are important and help create a stronger, more balanced understanding of what matters most to the community.

Understanding the Conceptual Options

What Are the Conceptual Options?

The conceptual options presented during this workshop are [exploratory planning tools](#) intended to help us understand community values, priorities, opportunities, and concerns – **not predetermined proposals or approved directions**. The concept sketches are intentionally high-level and simplified. They communicate the general organization and relationship of uses and program elements, rather than detailed designs. They are intended to:

- Illustrate different ways the Fairgrounds site could function
- Explore possibilities (how uses and amenities could potentially work together)
- Help identify opportunities, priorities, and trade-offs
- Support informed community discussion
- Test assumptions
- Refine potential directions

The concepts are not final designs, development proposals, or approved plans.

Important Notes About the Concepts

These Are Conceptual Illustrations

The options shown are high-level and intentionally flexible.

They do not represent:

- Final layouts or approved directions
- Approved development plans
- Exact building locations
- Detailed engineering or landscape designs
- Final amenity commitments

Specific elements may change or evolve as the process continues.

Imagery Is Illustrative Only

The associated imagery shown throughout the workshop materials are visual references intended to help communicate ideas, scale, atmosphere, or types of uses.

These images:

- May not represent the Fairgrounds directly
- Are not intended to show final designs
- Should be interpreted as inspiration or examples only

Imagery is intended to support discussion and help participants visualize possibilities.

Amenities Are Exploratory

Amenities shown within the conceptual options are examples of how spaces could potentially function.

Examples may include:

- Trails and pathways
- Open green spaces
- Gathering areas
- Community event spaces
- Agricultural or educational uses
- Flexible recreation spaces
- Multi-use facilities

Not all amenities shown would necessarily be included in a future concept or plan.

Site “Givens” & Technical Considerations

‘Givens’ for Draft Conceptual Options

As presented in the Interim Report and confirmed by Council direction, the following represent key principles that each concept option has been designed to reflect:

- Space for the annual Fair and core fairground functions
- Public access and a community-serving site
- Park-like improvements that support everyday use
- Exploration of flexible, multi-use spaces and facilities
- Exploration of programs and spaces that support community connection and potential revenue generation
- Exploration of how the site could respond to evolving community needs over time, where changes remain compatible with Fairgrounds functions and public access
- Ability to phase improvements over time

Design & Technical Considerations

To ensure the concepts are both practical and implementable, the following considerations have been applied consistently across all options:

- **Multi-Use Compatibility:** Concepts are designed to support a mix of recreational, cultural, and civic uses, reflecting how the site functions throughout the year.
- **Flexibility:** Spaces are arranged to accommodate a range of activities, with the ability to adapt over time. Specific amenities are not fixed and can evolve based on future needs and priorities.
- **Access & Servicing:** Existing vehicular access points are generally maintained where possible, minimizing the need for significant new infrastructure.
- **Circulation:** Internal movement is organized to support both day-to-day use and larger events, including safe and efficient pedestrian and vehicle flow.
- **Existing Infrastructure:** Buildings and services are generally maintained where practical to limit costs. Any new built form is assumed to require appropriate servicing and accessibility upgrades.
- **Parking:** Concepts primarily rely on on-site parking solutions, with flexibility to accommodate different scales of use.
- **Fair Use Retention:** The continued use of the site for Fair activities is maintained across all concepts.
- **Activity Compatibility:** Site arrangements are designed to minimize impacts on surrounding uses and support compatibility with the neighbouring community.
- **Fiscal Responsibility:** Approaches aim to balance capital and operating costs while considering the ability to support long-term sustainability. Concepts are also intended to help explore how improvements or changes could be phased and prioritized over time.
- **Strategic Growth:** Opportunities for phased implementation and partnerships are considered to support long-term viability.
- **Land Use:** Options may explore a range of community-serving uses and facilities where appropriate and compatible with the broader vision, including potential mixed-use or community-oriented opportunities.













1A REINFORCING THE EXISTING LAYOUT

This concept builds primarily on the existing site's functions and improvements, maintaining the overall structure. Entrances are enhanced as tree-lined boulevards with gateway features such as public art. The existing uses mostly remain in their current locations. The livestock building is relocated to the recreation / fairgrounds area. The track remains in place. An urban forest area is created in a portion of the track infield next to an expanded community garden and urban farm area. The area adjacent to the residential neighbourhood is transformed into a

community park. Trails are provided throughout the site. Existing buildings are all upgraded to meet municipal asset and building code standards and applicable Accessibility For Ontarians with Disabilities Act (AODA) requirements. Parking remains generally uncontrolled, making use of available spaces and the track during events as necessary. The intent is to reinforce the existing park site by improving its function and supporting more consistent use throughout the year.

Disclaimer

Imagery shown are examples of how different areas of the site could be used for inspiration. They illustrate possibilities rather than final designs. Some elements are generally tied to existing infrastructure and circulation needs, as well as how the site functions during events and day-to-day use. Other amenities are more flexible and can be refined over time based on community priorities and future needs.

-  Recreation / Fairgrounds
-  Paved Surfaces
-  Pathways
-  Outbuildings
-  Serviced Outbuildings
-  Existing Outbuildings
-  Washrooms
-  Parking
-  Overflow Parking
-  Urban Farm & Community Garden
-  Urban Forest Park Area
-  Hillside Amphitheatre
-  Agricultural / Exhibition Ring
-  Gateway Feature Entrances
-  Recreation / Fairgrounds
-  Community Green
-  Livestock / Show Area & Building
-  Neighbourhood Park
-  Track
-  Terrace Seating
-  Community Facility

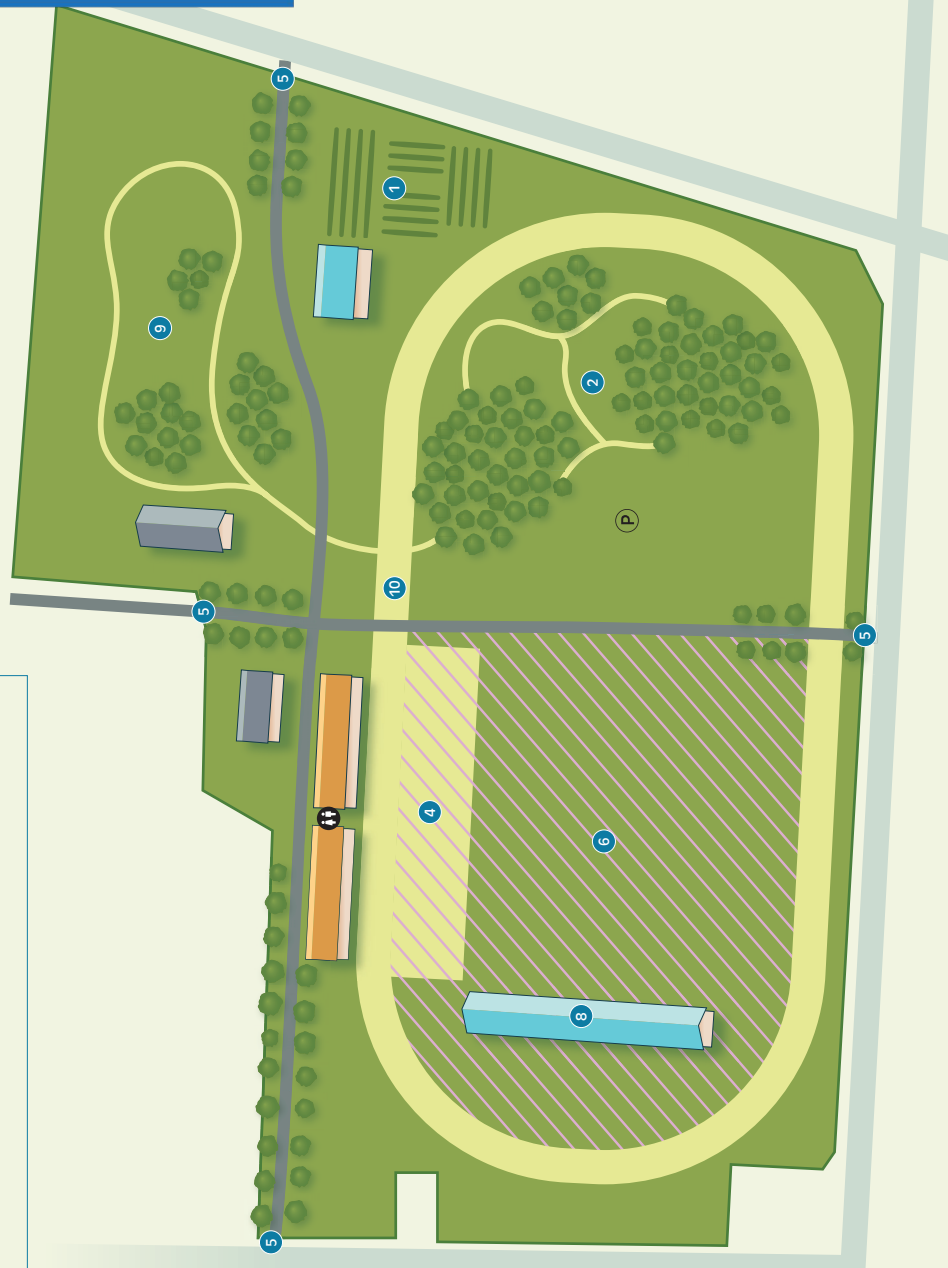

1B ENHANCING CIRCULATION & OPEN SPACE

This concept improves the functions of the various uses on the site. The existing uses remain in their current locations. Entrances are enhanced as tree-lined boulevards with gateway features such as public art. The area of the track used for parking is replaced with a purpose-built parking area adjacent to the recreation grounds to allow for ease of access for event logistics. A network of narrow pathways provides vehicular circulation around the site. The track is replaced with more greenspace and urban forest park area. The former infield of the track includes the recreation grounds for the fair and more intensive uses, as well as a

community green for event overflow and less intensive uses. The area adjacent to the residential neighbourhood is transformed into a community park with a small hillside amphitheatre integrated into the landscape and the community garden is expanded into an urban farm area across the boulevard. Trails are provided throughout the site. Existing buildings are all upgraded to meet municipal asset and building code standards and applicable Accessibility for Ontarians with Disabilities Act (AODA) requirements. The intent is to create more well-defined spaces that support a broader range of uses throughout the year.

Disclaimer

Imagery shown are examples of how different areas of the site could be used for inspiration. They illustrate possibilities rather than final designs. Some elements are generally tied to existing infrastructure and circulation needs, as well as how the site functions during events and day-to-day use. Other amenities are more flexible and can be refined over time based on community priorities and future needs.

- Recreation / Fairgrounds
- Paved Surfaces
- Pathways
- Outbuildings
- Serviced Outbuildings
- Existing Outbuildings
- Washrooms
- Parking
- Overflow Parking
- Urban Farm & Community Garden
- Urban Forest Park Area
- Hillside Amphitheatre
- Agricultural / Exhibition Ring
- Gateway Feature Entrances
- Recreation / Fairgrounds
- Community Green
- Livestock / Show Area & Building
- Neighbourhood Park
- Track
- Terrace Seating
- Community Facility

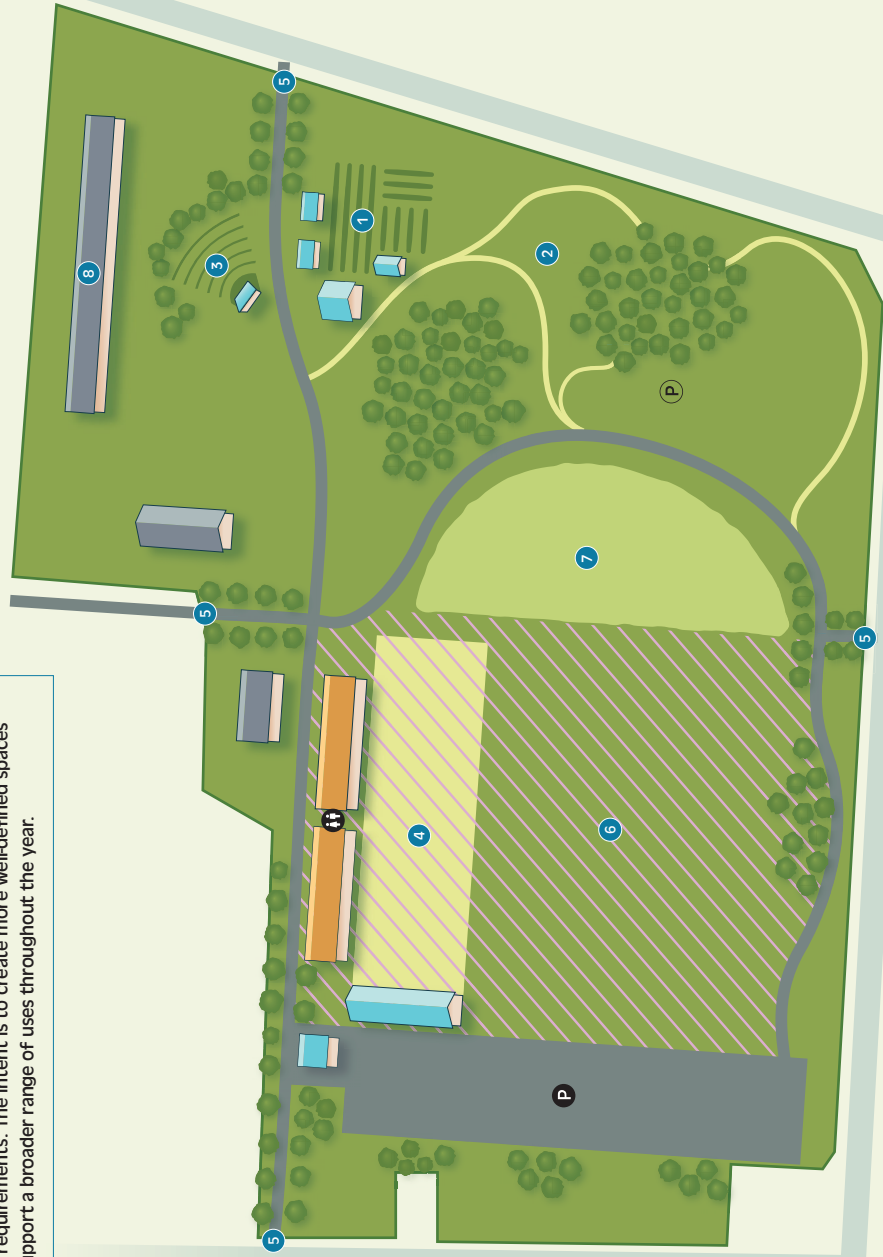













10 EXPANDING FACILITIES & USE AREAS

This concept improves the functions of the various uses on the site. The existing uses remain in their current locations. Entrances are enhanced as tree-lined boulevards with gateway features such as public art. The area of the track used for parking is replaced with two purpose-built parking areas; one centrally located, and a larger one adjacent to the recreation grounds to allow for ease of access for event logistics. A network of narrow parkways provides vehicular circulation around the site. The track is replaced with more greenspace, larger community green and urban forest park area. The recreation grounds remain for the fair and other more intensive uses. The community green acts as event

overflow and provides space for less intensive uses. The area adjacent to the residential neighbourhood is transformed into a community park with a small hillside amphitheatre integrated into the landscape, and the community garden is expanded into an urban farm area across the boulevard. Trails are provided throughout the site. Existing buildings are all upgraded to meet municipal asset and building code standards and applicable Accessibility for Ontarians with Disabilities Act (AODA) requirements. Additional buildings to support uses in the recreation grounds are provided. The intent is to create more well-defined spaces that support a broader range of uses throughout the year.

Disclaimer

Imagery shown are examples of how different areas of the site could be used for inspiration. They illustrate possibilities rather than final designs. Some elements are generally tied to existing infrastructure and circulation needs, as well as how the site functions during events and day-to-day use. Other amenities are more flexible and can be refined over time based on community priorities and future needs.

-  Recreation / Fairgrounds
-  Paved Surfaces
-  Pathways
-  Outbuildings
-  Serviced Outbuildings
-  Existing Outbuildings
-  Washrooms
-  Parking
-  Overflow Parking
-  1 Urban Farm & Community Garden
-  2 Urban Forest Park Area
-  3 Hillside Amphitheatre
-  4 Agricultural / Exhibition Ring
-  5 Gateway Feature Entrances
-  6 Recreation / Fairgrounds
-  7 Community Green
-  8 Livestock / Show Area & Building
-  9 Neighbourhood Park
-  10 Track
-  11 Terrace Seating
-  12 Community Facility

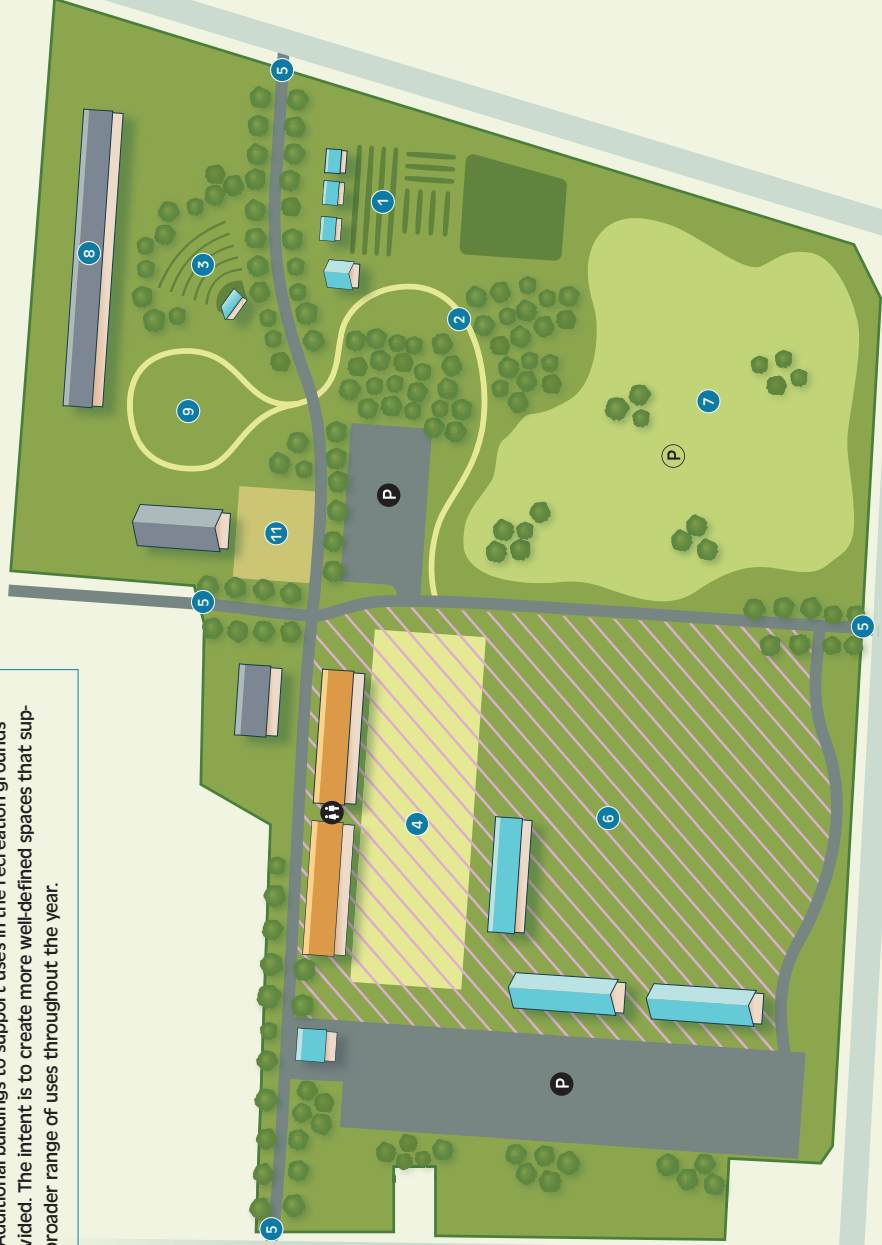

2 INTEGRATING COMMUNITY & MIXED-USE

This concept explores a different approach by introducing a mixed-use or community facility as part of the overall site. It considers how additional uses could be integrated alongside open space and existing activities, creating opportunities to meet evolving community needs. This option reflects a more significant shift in how the site functions, while still maintaining public access and a connection to the broader community uses of the site. This concept also includes: tree-lined boulevard entrance with gateway features such as public art; two purpose-built parking

areas with ease of access for event logistics; network of narrow parkways; more greenspace; larger community green and urban forest park area; a community park; urban farm area; and trails throughout the site. Existing buildings are all upgraded to meet municipal asset and building code standards and applicable Accessibility for Ontarians with Disabilities Act (AODA) requirements. Additional buildings to support uses in the recreation grounds are provided.

Disclaimer

Imagery shown are examples of how different areas of the site could be used for inspiration. They illustrate possibilities rather than final designs. Some elements are generally tied to existing infrastructure and circulation needs, as well as how the site functions during events and day-to-day use. Other amenities are more flexible and can be refined over time based on community priorities and future needs.

- Recreation / Fairgrounds
- Paved Surfaces
- Pathways
- Outbuildings
- Serviced Outbuildings
- Existing Outbuildings
- Washrooms
- Parking
- Overflow Parking
- Urban Farm & Community Garden
- Urban Forest Park Area
- Hillside Amphitheatre
- Agricultural / Exhibition Ring
- Gateway Feature Entrances
- Recreation / Fairgrounds
- Community Green
- Livestock / Show Area & Building
- Neighbourhood Park
- Track
- Terrace Seating
- Community Facility

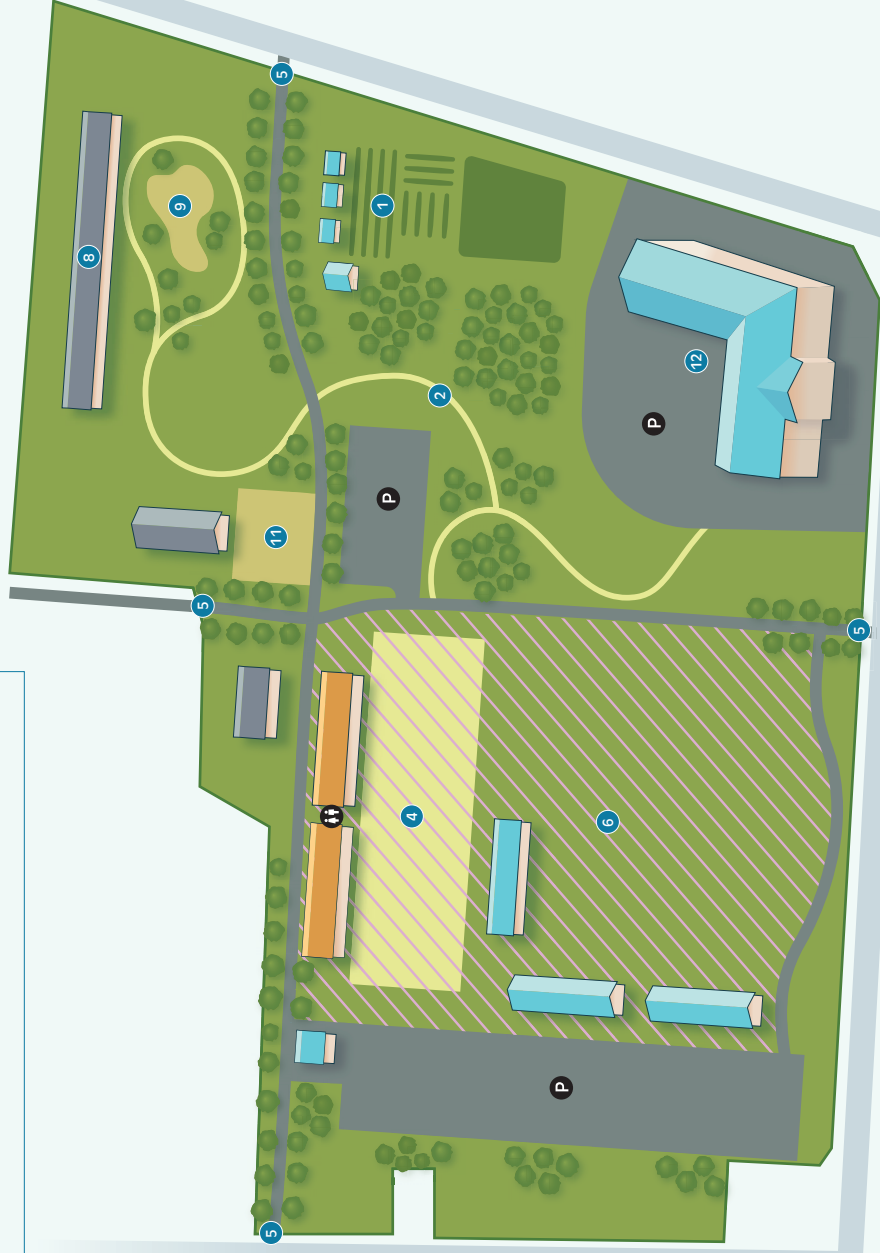

KEY ELEMENT DESCRIPTIONS & IMAGERY

1

Urban Farm & Community Garden

A productive open-space area dedicated to local food growing, education, and community development activities. It supports small-scale agriculture, shared gardening, and community gathering in a public and accessible setting. This area should be designed to be easily navigable with clear circulation and plot organization. Walkways and gardening work areas should be designed for universal accessibility and ease of maintenance.

Typical Features Include

- raised planting beds
- in-ground plots
- accessible garden plots
- greenhouses
- cold frames
- composting areas
- tool storage
- pollinator gardens
- demonstration planting areas
- food preparation stations
- seating
- shade
- gathering spaces
- water service

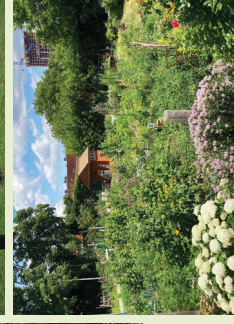

Reference: Care and Share Community Garden, Port Perry; McQueen Urban Farm, Hamilton; Symington Community Garden, Toronto; Black Creek Community Farm, Toronto; Richmond Fairgrounds, Ottawa

+

Additional Amenities

Supporting amenities, such as washrooms, seating areas, and accessible pathways, should be considered to enhance user comfort and usability. Where appropriate, parking and bicycle facilities should also be incorporated to improve access. These amenities should be thoughtfully integrated into the landscape to maintain the open, informal character of the space.



4

Agricultural/Exhibition Ring

A central demonstration and display space for agricultural events, horse exhibitions, shows, and seasonal exhibition activities and ceremonies. It supports the central fair events and public-facing programming and is capable of handling temporary and high-intensity use.

Typical Features Include

- ring fencing
- gates
- bleachers
- announcer facilities
- lighting
- service access
- event stage

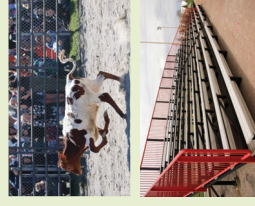

Reference: Port Perry Fair, Uxbridge Fair

KEY ELEMENT DESCRIPTIONS & IMAGERY

2

Urban Forest Park Area

A wooded landscape that provides habitat with indigenous species and creates spaces for passive recreation and enjoyment of nature. It functions as an environmental asset, healthy public space, and visually attractive feature of the site.

Typical Features Include

- tree groves and understory planting
- naturalized clearings, walking trails and seating areas
- interpretative signage and pathways
- bird-friendly and pollinator plantings

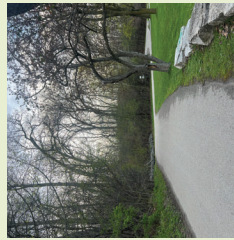

Reference: Elgin Park, Uxbridge; Collingwood Arboretum; Eco Garden, Penetanguishene; High Park, Toronto



3

Hillside Amphitheatre

An outdoor seating and gathering space integrated into the landscape for viewing performances, ceremonies, and community events, serving as a social focal point. The design should include accessibility features.

Typical features include

- tiered grass or hardscape seating
- performance stage or platform
- event lighting and sound infrastructure

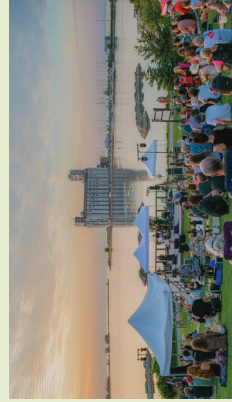
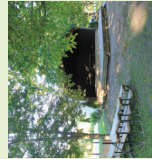
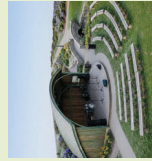
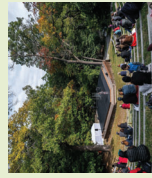

Reference: Elgin Park, Uxbridge; Toronto Island Park, Shipyard Amphitheatre, Collingwood; High Park, Toronto

6

Recreation / Fairgrounds

A flexible multi-use open space for recreation, community events, and fair-related programming. It is the adaptable heart of the site and should accommodate everyday use and seasonal events and gatherings. This area may be supported by various buildings designed for logistical needs and hosting events and gatherings.

Typical Features include

- open lawn
- ability to support the use of tents, markets, and festival infrastructure
- temporary power access
- shade structures
- washrooms
- storage

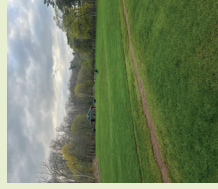

Reference: Port Perry Fair; Food Truck Fair, Collingwood; High Park, Toronto; Palmer Park, Port Perry

KEY ELEMENT DESCRIPTIONS & IMAGERY

11

Terrace Seating

A landscaped seating area for viewing, gathering, or informal activities. It can function as an outdoor room, overflow seating for events, meeting point, or a transition space between the other areas of the site.

Typical Features Include

- casual seating
- integrated planters
- shade structures or trees
- access to a restroom



Reference: High Park, Toronto; Farmers Market, Owen Sound; Eco Garden, Penetanguishene; Boyd Conversation Area

9

Neighbourhood Park

A park space designed primarily for everyday neighbourhood use, recreation, and family activity. It provides a quieter, more intimate counterpart to the larger fairground spaces and includes spaces specifically designed for families and children to play and gather.

Typical Features Include

- playground equipment
- seating
- shade trees
- pathways
- picnic areas
- nature-play area



Reference: Elgin Park, Uxbridge; Sunset Park, Collingwood; Symington Park, Toronto; High Park, Toronto

5

Gateway Feature Entrances

Landmark entrances with element that announces arrival and establish the identity of the fairgrounds site. These create an identifiable and memorable gateway experience between the surrounding community and the site. These are designed with landscape and built features that make them high visibility from adjacent streets and approaches.

Typical Features Include

- entry signage
- public art
- landscape markers
- lighting
- drop-off areas
- pedestrian access points
- wayfinding features
- seasonal banners
- event branding
- meeting points for visitors

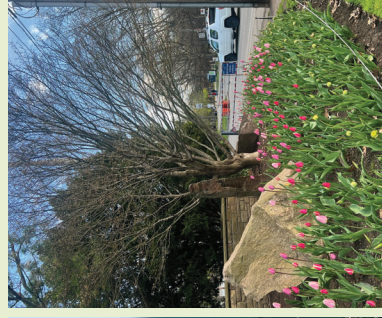
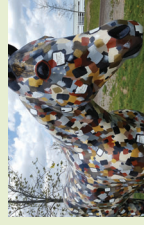

Reference: Port Perry Fairgrounds; Chorley Park, Toronto; High Park, Toronto; Palmer Park, Port Perry; Caledon Sculpture



KEY ELEMENT DESCRIPTIONS & IMAGERY

12

Community Facility

A civic-focused use / building that integrates well into the park setting of the site, such as seniors housing or community centre.

Reference: Caledon Seniors Centre, Bolton; Lanark Lifestyles, Perth



7

Community Green

A central shared green space that supports everyday community life, informal recreation, and social gathering. It serves as a unifying open-space element within the broader fairgrounds plan.

Typical Features Include

- informal seating
- picnicking area
- spaces for informal sports, play, and community gatherings and small events
- shade trees
- lawns
- public art
- drinking fountains
- lighting

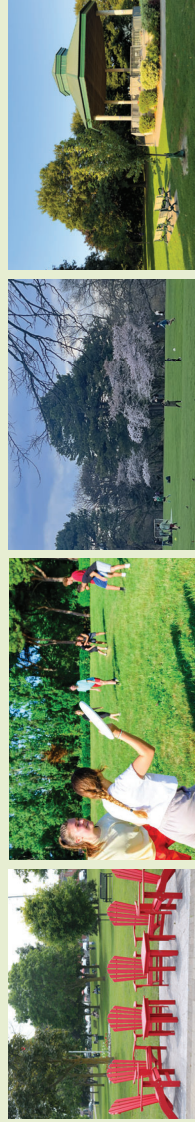
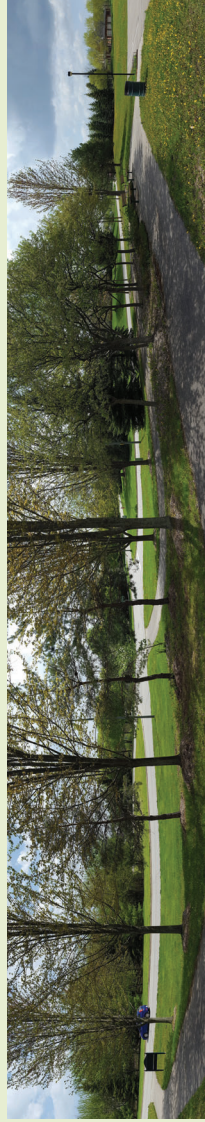

Reference: Elgin Park, Uxbridge; Earls Court, Toronto; High Park, Toronto; Palmer Park, Port Perry; Symington Park, Toronto

8

Livestock / Show Area & Building

A purpose-built area for animal handling, exhibition, and agricultural programming. It supports the educational and ceremonial aspects, youth programs, and livestock exhibitions of the fairgrounds while maintaining safe operation for people, animals, and equipment.

Typical Features Include

- stalls
- pens
- wash areas
- holding areas
- grooming spaces
- judging areas
- demonstration space
- storage
- utilities
- washrooms



Reference: Port Perry Fair

10

Track

A dedicated track for informal recreational, demonstrations, training, and community events.

Typical Features Include

- well-drained surface
- fencing

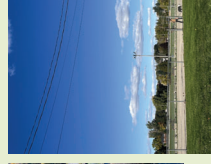
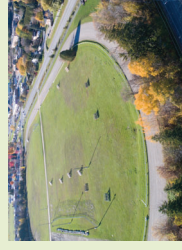

Reference: Port Perry Fairgrounds